

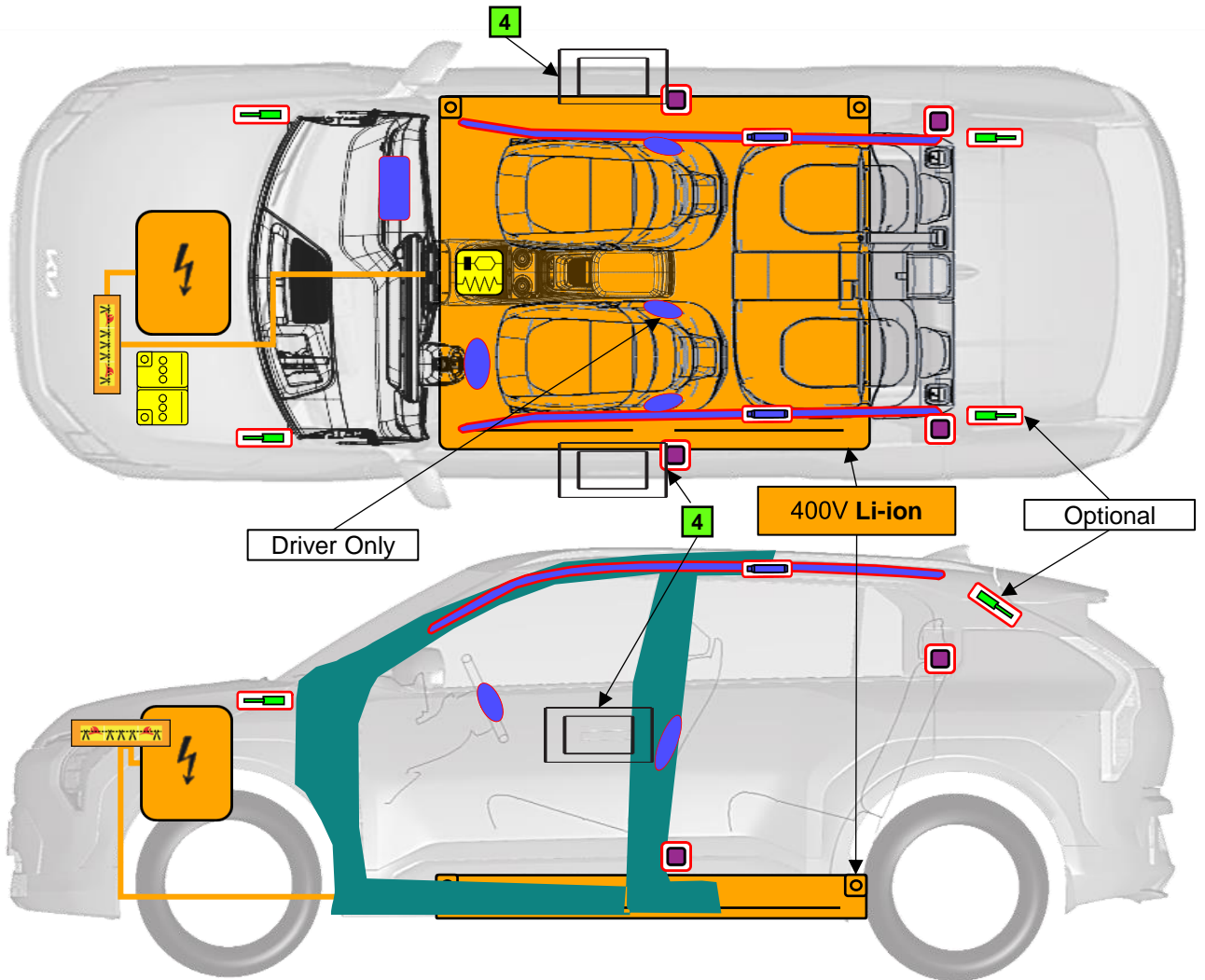

**Kia EV3 Electric**  
SUV, 5doors  
From 2024



	Airbag		Stored gas inflator		Seat belt pretensioner		SRS control unit
	Battery low-voltage		Gas strut / Preloaded spring		High strength zone		Zone requiring special attention
	Battery pack, high-voltage		High voltage power cable		High voltage component		Cable Cut

# 1. Identification / recognition



LACK OF ENGINE NOISE DOES NOT MEAN VEHICLE IS OFF: SILENT MOVEMENT OR INSTANT RESTART CAPABILITY EXISTS UNTIL VEHICLE IS FULLY SHUT DOWN.

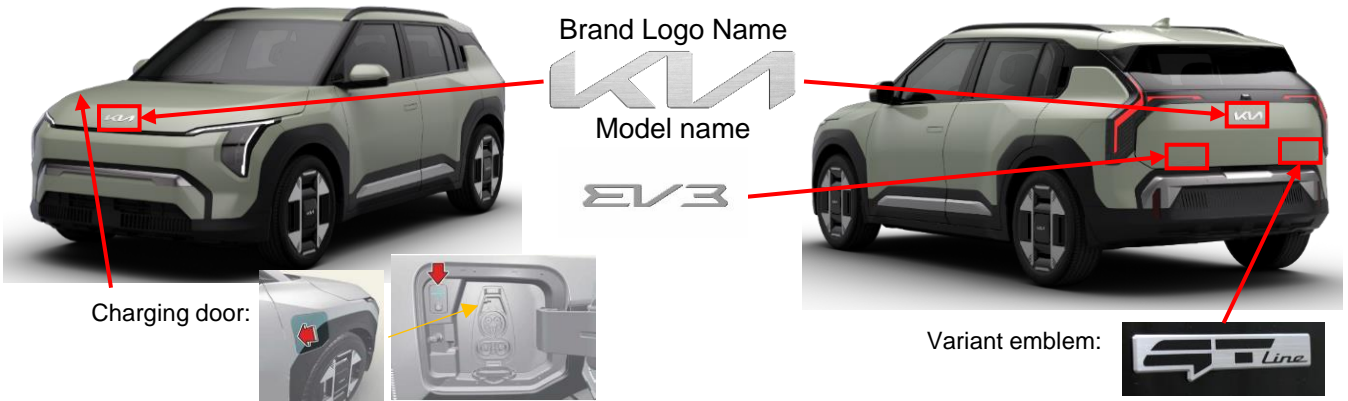

# 2. Immobilisation / stabilisation / lifting

## Immobilization:

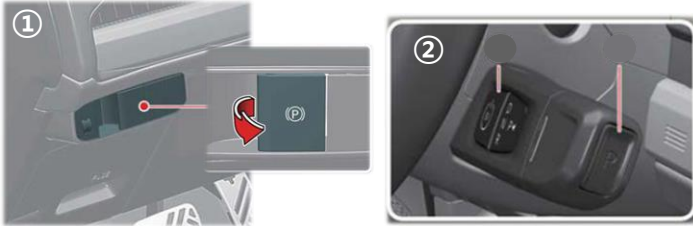

- ① Chock the wheels and pull the electronic parking brake switch to set the parking brake.
- ② For automatic vehicles the shift button to the park(P) position.

For stabilize vehicle, crib at four points directly under the front and rear pillars using wooden blocks or equivalent objects

## Lifting points under the vehicle:

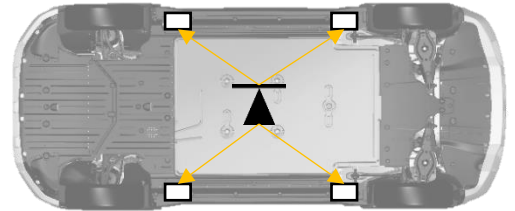

# 3. Disable direct hazards / safety regulations

IN CASE OF AN ACCIDENT, WHERE AIRBAGS AND SEATBELT PRETENSIONER WERE ACTIVATED, THE HV-SYSTEM SWITCH'S OFF AUTOMATICALLY. FOR ALL OTHER CASES USE THE DISABLING METHODS BELOW



## Disabling High Voltage Battery: Access:



① Pull the hood release lever (1) on the driver side.



③ Open the cover with the firefighter helmet

② Go to the front of the vehicle. Push the secondary hood release lever (2) to the left.



④ The service interlock is on the left side of the battery.

## Disabling:



Cut the cable of the service interlock to disable the HV-System

There is the capacitor inside the HPCU. Wait 5+ minutes for the capacitor to discharge after removing the service plug.



## Disabling 12V Battery:

Turn the ignition switch off.  
Follow step ①-③ from disabling HV-method to get access to the 12V Battery

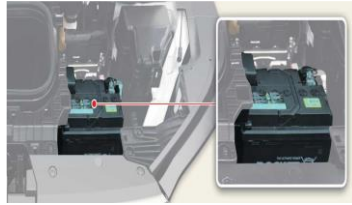

Disconnect the negative(-) terminal

Disconnect the positive(+) terminal

## 4. Access to the occupants

### Steering column adjustment:



### Seat adjustment:

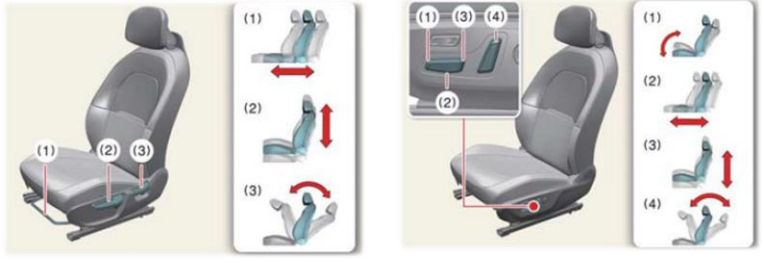

Manual

Power

**Glass:** ①:Laminated ③④:Tempered  
②:Tempered  
(OPT : Laminated)

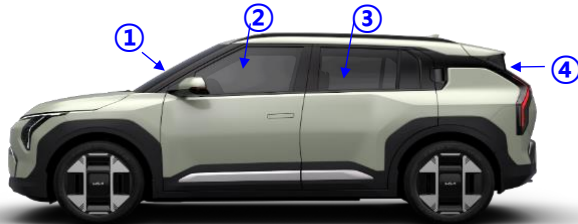

### Vehicle body → Hardened Steel

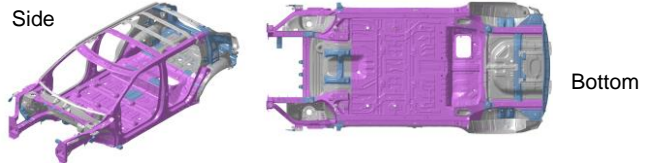

### Tailgate:









Remove the cover at the bottom of the tailgate, then slide the latch in the direction of the arrow to unlock the tailgate.

### Door handle:

When the door outer handle doesn't pop-out, push the front side inwards.

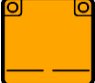

## 5. Stored energy / liquids / gases / solids

	   	12V	
 LI ION	     	400V	R-1234yf 850g
			 



WHEN COOLANT LEAKS FROM THE BATTERY PACK, IT CAN BECOME UNSTABLE WITH RISK OF THERMAL RUNAWAY. CHECK BATTERY PACK TEMPERATURE WITH THERMAL IMAGING CAMERA

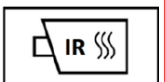

## 6. In case of fire



Use large amount of water



**BATTERY RE-IGNITION!**

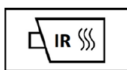

**Gas strut!**



Risk of missile effect of hood and tailgate.

## 7. In case of submersion



Do not touch any of the high-voltage components or cables including the high voltage cut-off switch, as doing so poses an electrocution hazard. Work on the vehicle only after the vehicle has been pulled out of the water.



## 8. Towing / transportation / storage

OK

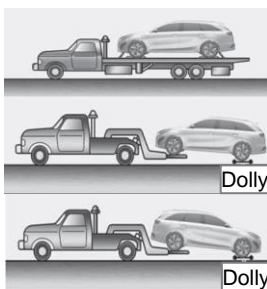

Notice: The use of wheel dollies or flatbed is recommended. Use a wheel lift or flatbed equipment.

Not OK

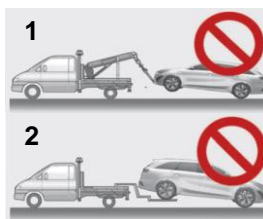

Notice : Do not tow with sling-type equipment (1). Do not tow the vehicle with the front wheels on the ground as this may cause damage to the vehicle (2).

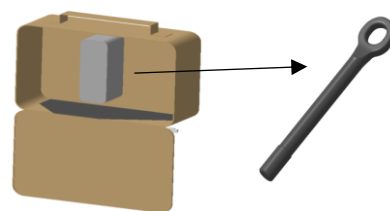

- Towing hock located in the tool case in the tailgate

The hook must be used only temporary towing.  
Store at safe distance from other vehicles

## 9. Important additional information

## 10. Explanation of pictograms used

	General warning sign		Warning, Electricity		Electric Vehicle
	Air-conditioning component		Use thermal Infrared camera		Use water to extinguish the fire
	Acute toxicity		Corrosives		Environmental hazard
	Explosive		Flammable		Hazardous to the human health
	Bonnet		Boot		