

Match abandoned

Just like you can't play football with a deflated ball—
You can't drive properly with a tyre that has low air pressure.



What Happens When Tyre Pressure Is Low?

- Reduced tyre lifespan
- Decreased braking power
- Lower fuel efficiency
- Unstable steering



You can check the recommended tyre pressure by opening the driver's door. Refer to the label attached to the centre pillar for the recommended tyre pressure.

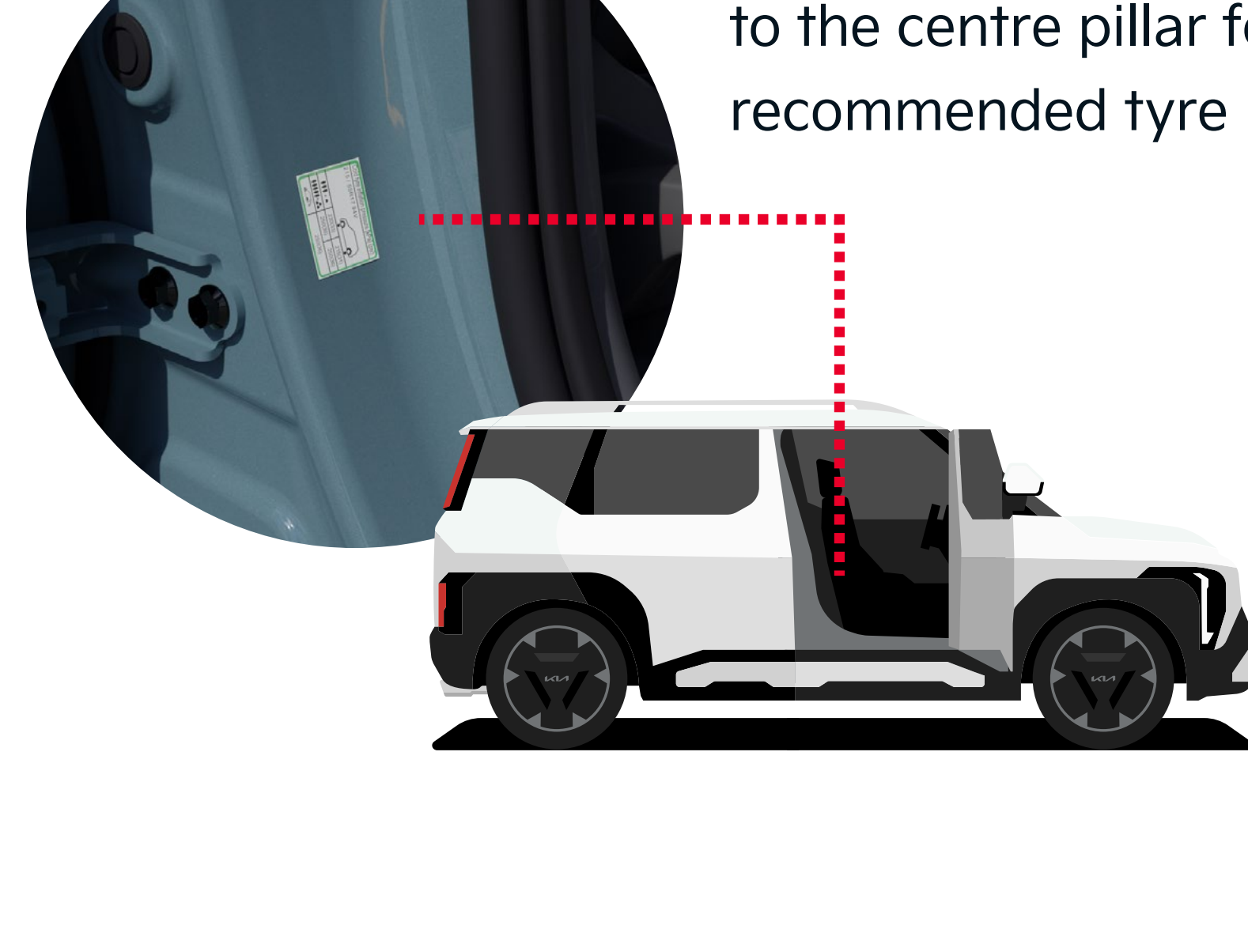

If the Tyre Pressure Warning Light Comes On

- 1 Slow down and park in a safe place.
- 2 Check the cluster to see which tyre has low pressure.

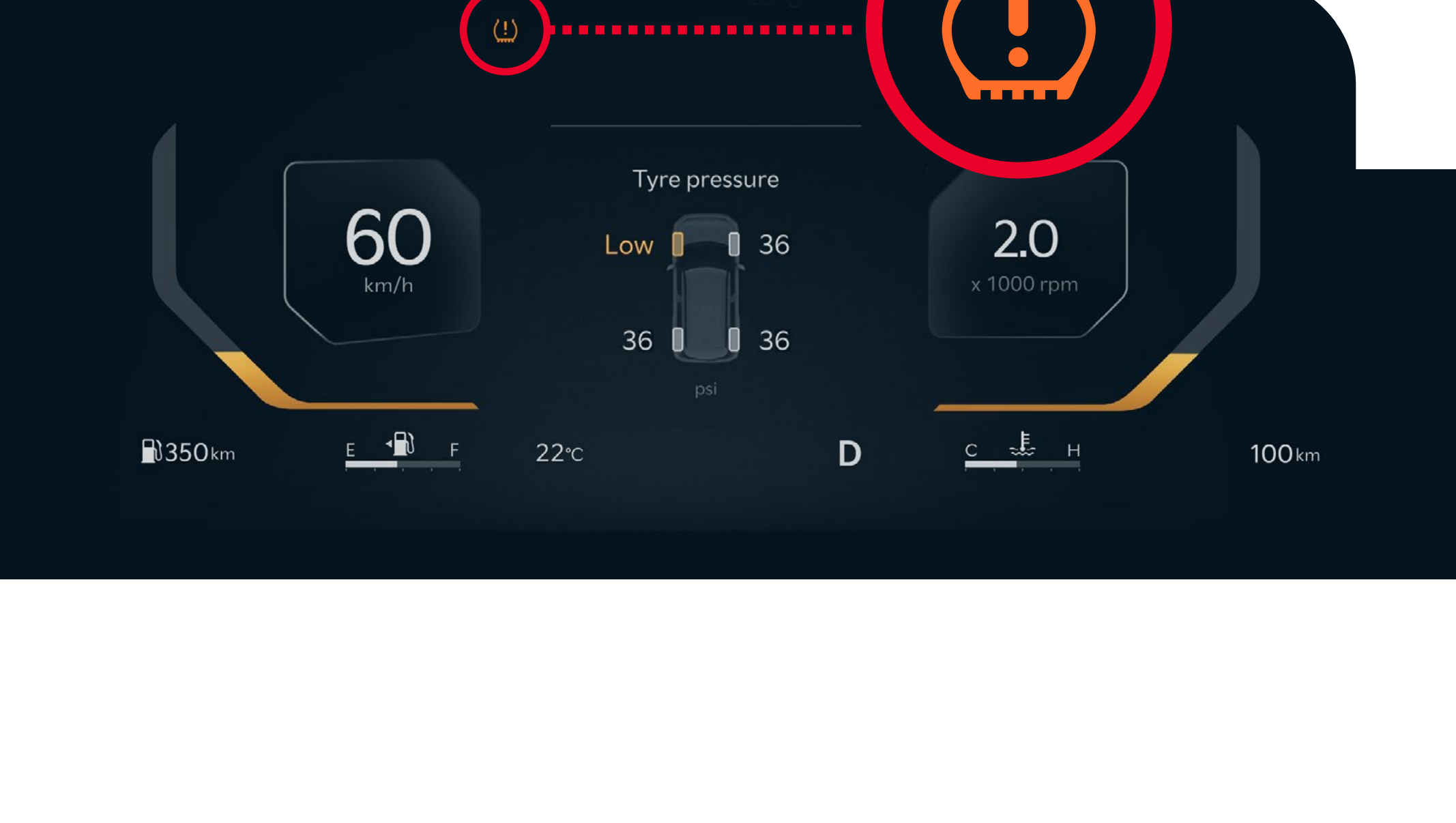

If the vehicle is equipped with a Tyre Mobility Kit (TMK), you can use it to inflate the tyre.

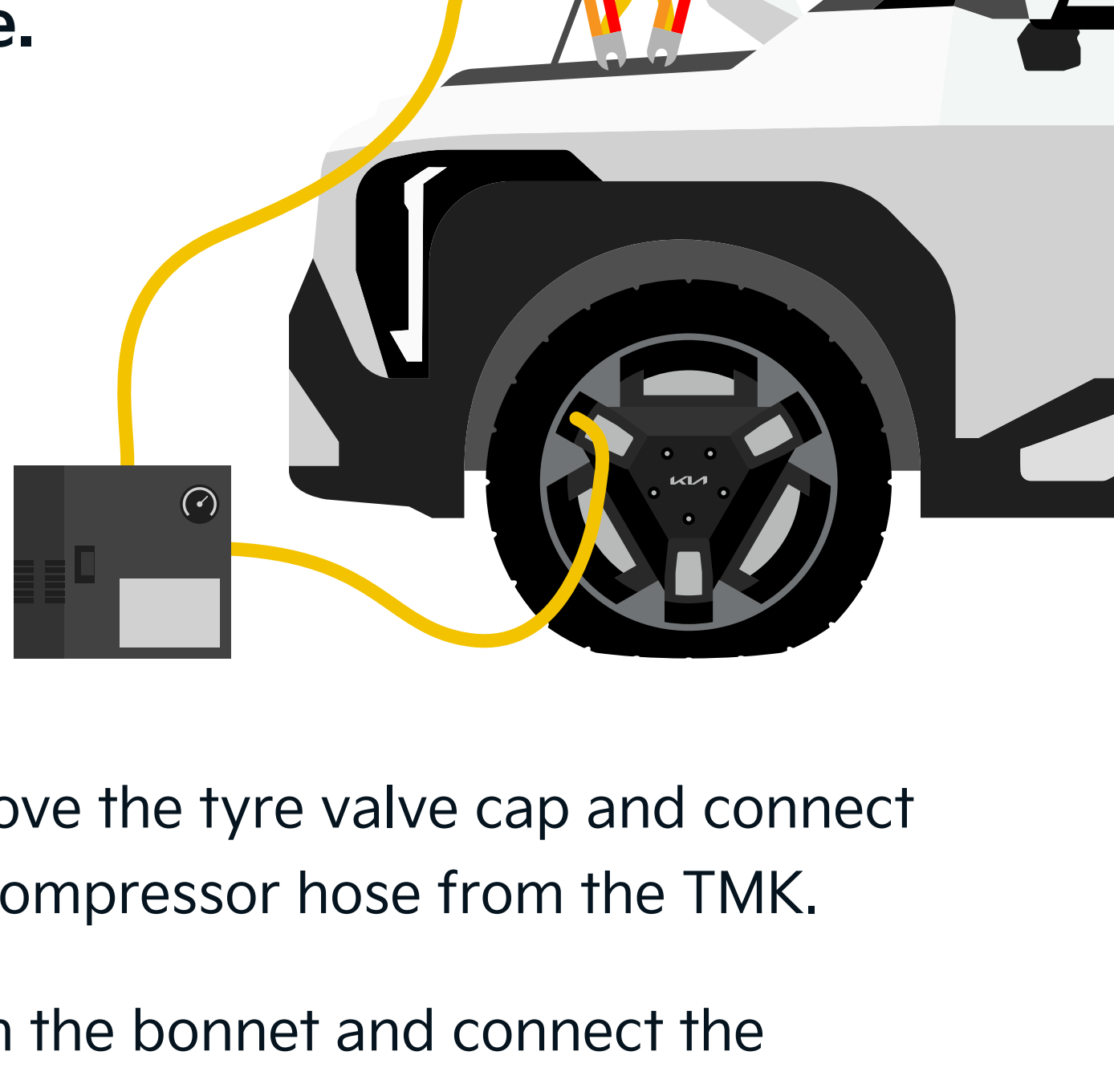

- Step 1. Remove the tyre valve cap and connect the compressor hose from the TMK.
- Step 2. Open the bonnet and connect the compressor cable to the 12V battery.
- Step 3. Start the engine and operate the compressor to inflate the tyre to the recommended pressure.

If the warning light remains on after you have inflated the tyre, you likely have a puncture. Inject the sealant from the TMK to seal the damaged area.

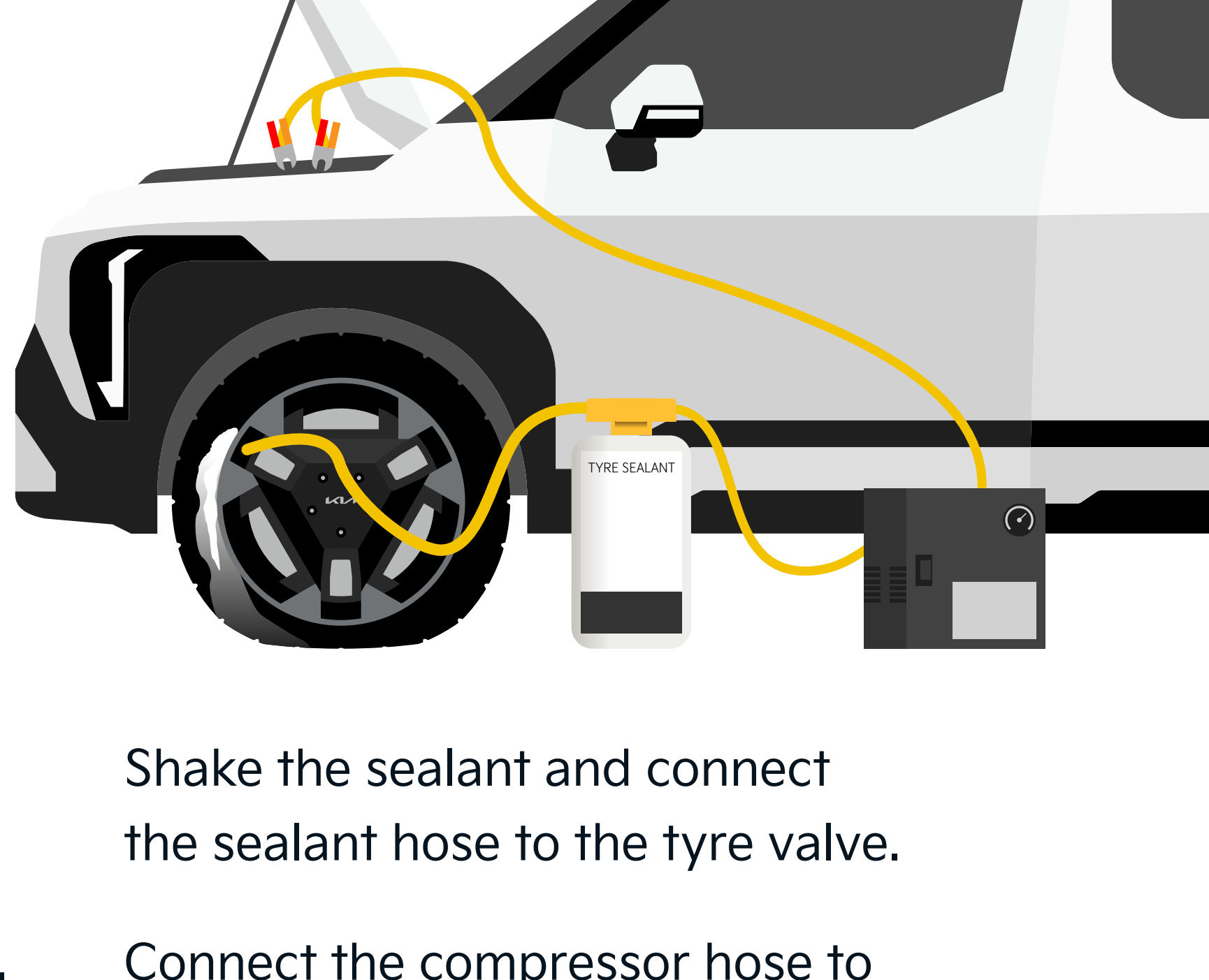

- Step 1. Shake the sealant and connect the sealant hose to the tyre valve.
- Step 2. Connect the compressor hose to the sealant hose.
- Step 3. Open the bonnet and connect the compressor cable to the 12V battery.
- Step 4. Start the engine and turn on the compressor to inject the sealant.
- Step 5. Drive at low speed for 10 minutes to evenly distribute the sealant.

If your vehicle is equipped with a spare tyre, you can replace the damaged one.

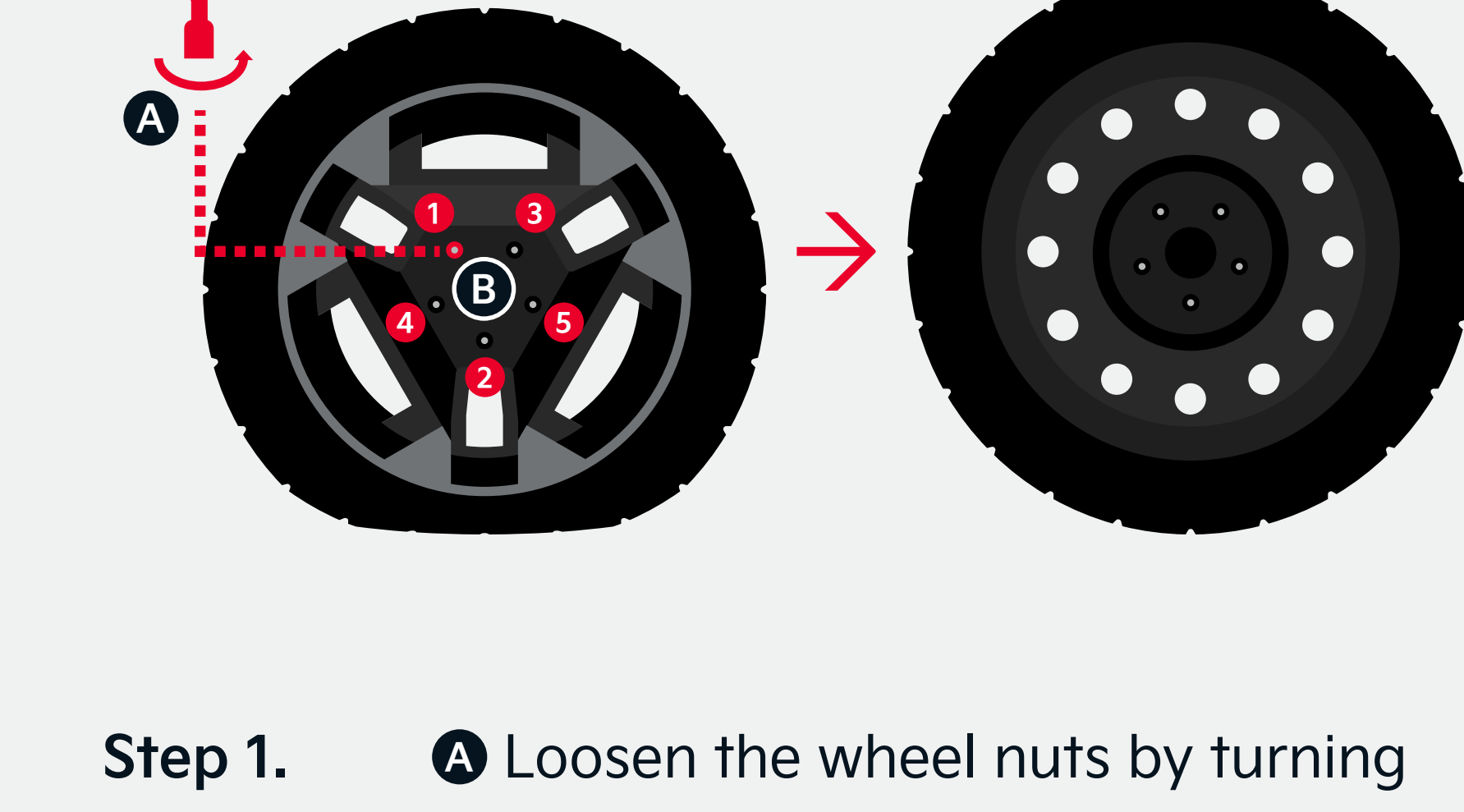

- Step 1. **A** Loosen the wheel nuts by turning them anticlockwise.
B Loosen them in a diagonal sequence. (1 ~ 5)
- Step 2. Use the jack and the jack handle to lift the vehicle, then fully loosen the wheel nuts and remove the tyre.
- Step 3. After mounting the spare tyre, hand-tighten the wheel nuts to hold it in place.
- Step 4. After lowering the vehicle to the ground, tighten the wheel nuts securely.

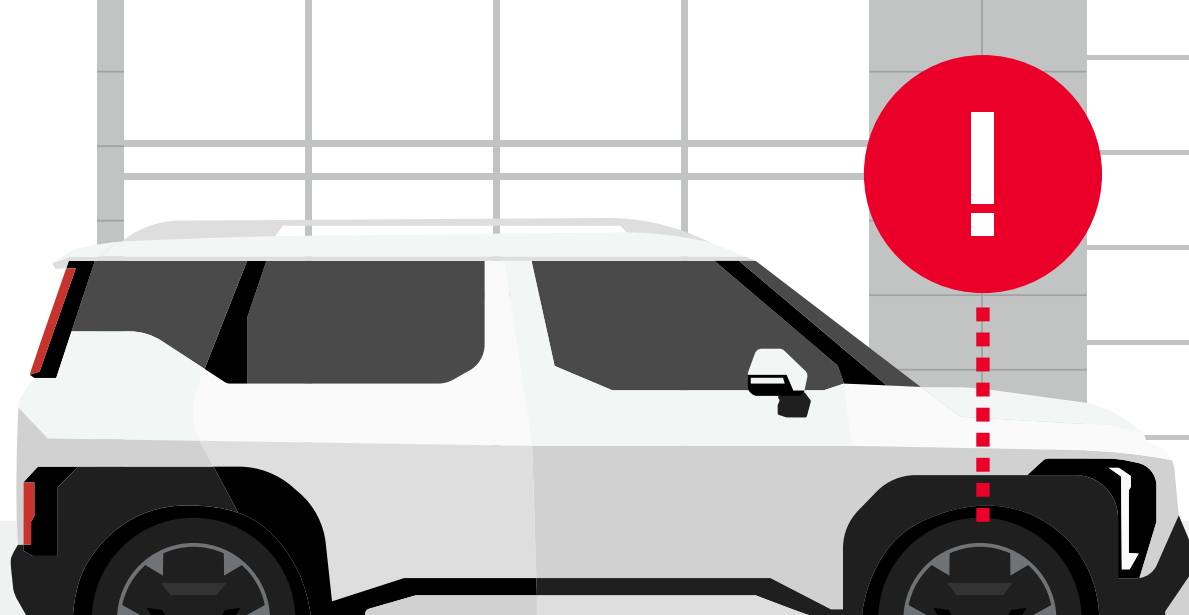

It's necessary to remove and clean the tyre after using sealant.

If you installed a compact spare tyre, replace it with a standard tyre as soon as possible.

Always visit an authorised Kia dealer after taking emergency measures.